

COUNTY OF LOS ANGELES

ROAD DEPARTMENT



BELLFLOWER QUAD

BENCH MARKS

1960

PREFACE

The Road Department level net is composed of some 1,000 miles of levels supporting more than 10,000 bench marks. In 1955, a major re-adjustment of the net was undertaken resulting in revised bench mark elevations of which the accompanying list is a part.

To facilitate the adjustment, indexing, and distribution of adjusted values of the net, the county territory was divided into 30 quads or areas. For identification purposes each quad was given a name, viz., "Rosemead", "La Mirada", "Santa Fe", etc. When bench marks and elevations in the Road Dept. net are used, the name of the quad in which the bench mark is located and the date of the adjustment of the elevation must be included in the bench mark description, e.g.,

SG 908 - L & T in E. cb. Muscatel Ave. on C/L prod.
Scott St. (Rosemead - 1955) Elev. 333.517

It is expected that this general adjustment will, for the most part, remain sound for the next 15 or 20 years. As new circuits are completed, however, re-adjustment of individual quads may become advisable. It is expected that these subsequent adjustments will be in the nature of a few hundredths of a foot. When a quad is re-adjusted, new elevation lists will be published and the date of the re-adjustment will replace the "1955" at the end of the bench mark description. Two bench marks in the same quad with different adjustment dates will not normally join each other. Since all adjustments taper out to nothing at the periphery of the quad, any bench mark in one quad will join any bench mark in another quad regardless of their respective adjustment dates.

The basic accuracy of the net is reflected by an indicated field probable error of ± 0.12 foot per mile of leveling as determined from 298 conditions of closure. However, many years experience in vertical control in the greater Los Angeles basin & Antelope Valley indicate that because of varying degrees of subsidence and heaving, the true datum is recovered only by obtaining substantial agreement of a number of bench marks.

The users of this net are invited to assist in its maintenance by notifying this Department of cases of obliteration, apparent mistakes in descriptions or elevations, and proven disturbance of bench marks.

Datum: U.S. Coast and Geodetic Survey Sea Level Datum of 1929, through the medium of the Los Angeles County Engineer Precise Level Net, 1952 Adjustment.

Abbreviations Used in Bench Mark Listings

ABUT--Abutment	L+BN--Lead and Bench Mark Nail
ANG PT--Angle Point	L+BR--Lead and Brad
BC--Beginning of Curve	L+N--Lead and Nail
BCR--Beginning of Curb Return	L+PK--Lead and PK Nail
BLDG--Building	L+SPK--Lead and Spike
BT SPK--Boat or Bolt Spike	L+T--Lead and Tack
CB RET--Curb Return	MCR--Middle of Curb Return
C/L INT--Center Line Intersection	MKD--Marked
C/L PROD--Center Line Produced	NR--Near
COE--Corps of Engineers	OPP--Opposite
CONC--Concrete	PI--Point of Intersection
CS MON--County Surveyor Monument	PK+W--PK Nail and Washer
CS BR CAP--County Surveyor Brass Cap Monument	P/L--Property Line
CT SPK--Cut Spike	P O S T--Point on Semi-tangent
CTR--Center	PP--Power Pole
DN--Down	PVMT--Pavement
DR--Driveway	R D--Road Department
EC--End of Curve	RDBM--Road Department Bench Mark
ENT--Entrance	RR--Railroad
FC--Flood Control (Dept. LA County)	SPK T+W--Spike, Tin and Washer
FTG--Footing	USC+GS--United States Coast and Geodetic Survey
HDWL--Headwall	USGS--United States Geological Survey
HSE--House	WK--Walk
IP--Iron Pipe	±--Plus or Minus
LACE--Los Angeles City Engineer	+--And

TO NORWALK QUAD

TO ARTESIA QUAD

COMPTON BLVD.

CLARK AVE.

ARDMORE AVE.

BELFLOWER BLVD.

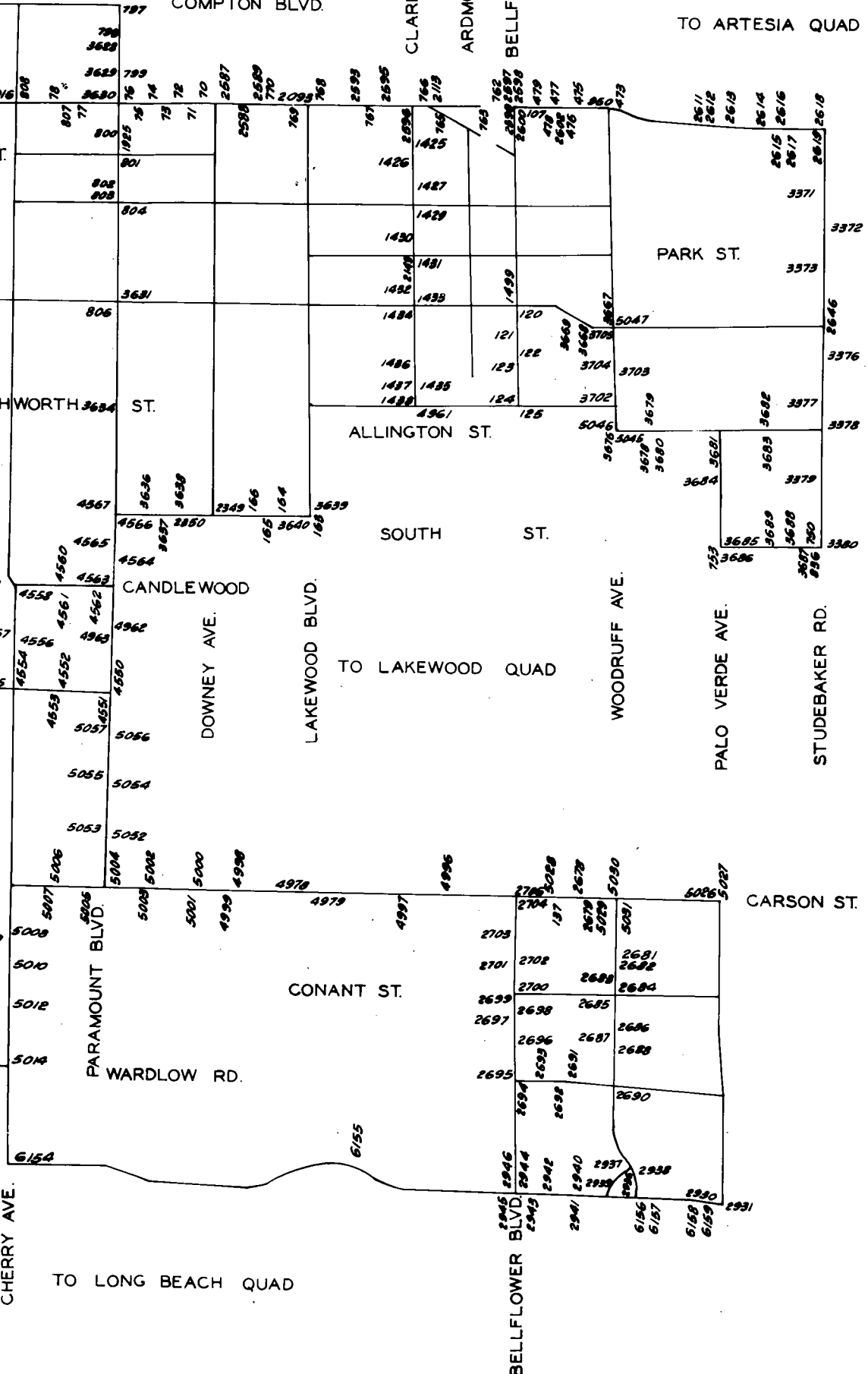

CHERRY AVE.

TO LONG BEACH QUAD

TO ARTESIA QUAD

CARSON ST.

CONANT ST.

PARAMOUNT BLVD.

WARDLOW RD.

CANDLEWOOD

DOWNEY AVE.

LAKEWOOD BLVD.

SOUTH ST.

ALLINGTON ST.

PARK ST.

WOODRUFF AVE.

PALO VERDE AVE.

STUDEBAKER RD.

6/55

BELFLOWER BLVD

2945

2944

2942

2940

2937

2938

6/56

6/57

6/58

6/59

2930

2931

4996

4997

4998

4999

5000

5001

5002

5003

5004

5005

5006

5007

5008

5009

5010

5011

5012

5013

5014

5015

5016

5017

5018

5019

5020

5021

5022

5023

5024

5025

5026

5027

5028

5029

5030

5031

5032

5033

5034

5035

5036

5037

5038

5039

5040

5041

5042

5043

5044

5045

5046

5047

5048

5049

5050

5051

5052

5053

5054

5055

5056

5057

5058

5059

5060

5061

5062

5063

5064

5065

5066

5067

5068

5069

5070

5071

5072

5073

5074

5075

5076

5077

5078

5079

5080

5081

5082

5083

5084

5085

5086

5087

5088

5089

5090

5091

5092

5093

5094

5095

5096

5097

5098

5099

5100

5101

5102

5103

5104

5105

5106

5107

5108

5109

5110

5111

5112

5113

5114

5115

5116

5117

5118

5119

5120

5121

5122

5123

5124

5125

5126

5127

5128

5129

5130

5131

5132

5133

5134

5135

5136

5137

5138

5139

5140

5141

5142

5143

5144

5145

5146

5147

5148

5149

5150

5151

5152

5153

5154

5155

5156

5157

5158

5159

5160

5161

5162

5163

5164

5165

5166

5167

5168

5169

5170

5171

5172

5173

5174

5175

5176

5177

5178

5179

5180

5181

5182

5183

5184

5185

5186

5187

5188

5189

5190

5191

5192

5193

5194

5195

5196

5197

5198

5199

5200

5201

5202

5203

5204

5205

5206

5207

5208

5209

5210

5211

5212

5213

5214

5215

5216

5217

5218

5219

5220

5221

5222

5223

5224

5225

5226

5227

5228

5229

5230

5231

5232

5233

5234

5235

5236

5237

5238

5239

5240

5241

5242

5243

5244

5245

5246

5247

5248

5249

5250

5251

5252

5253

5254

5255

5256

5257

5258

5259

5260

5261

5262

5263

5264

5265

5266

5267

5268

TO SOUTH GATE QUAD

TO NOR

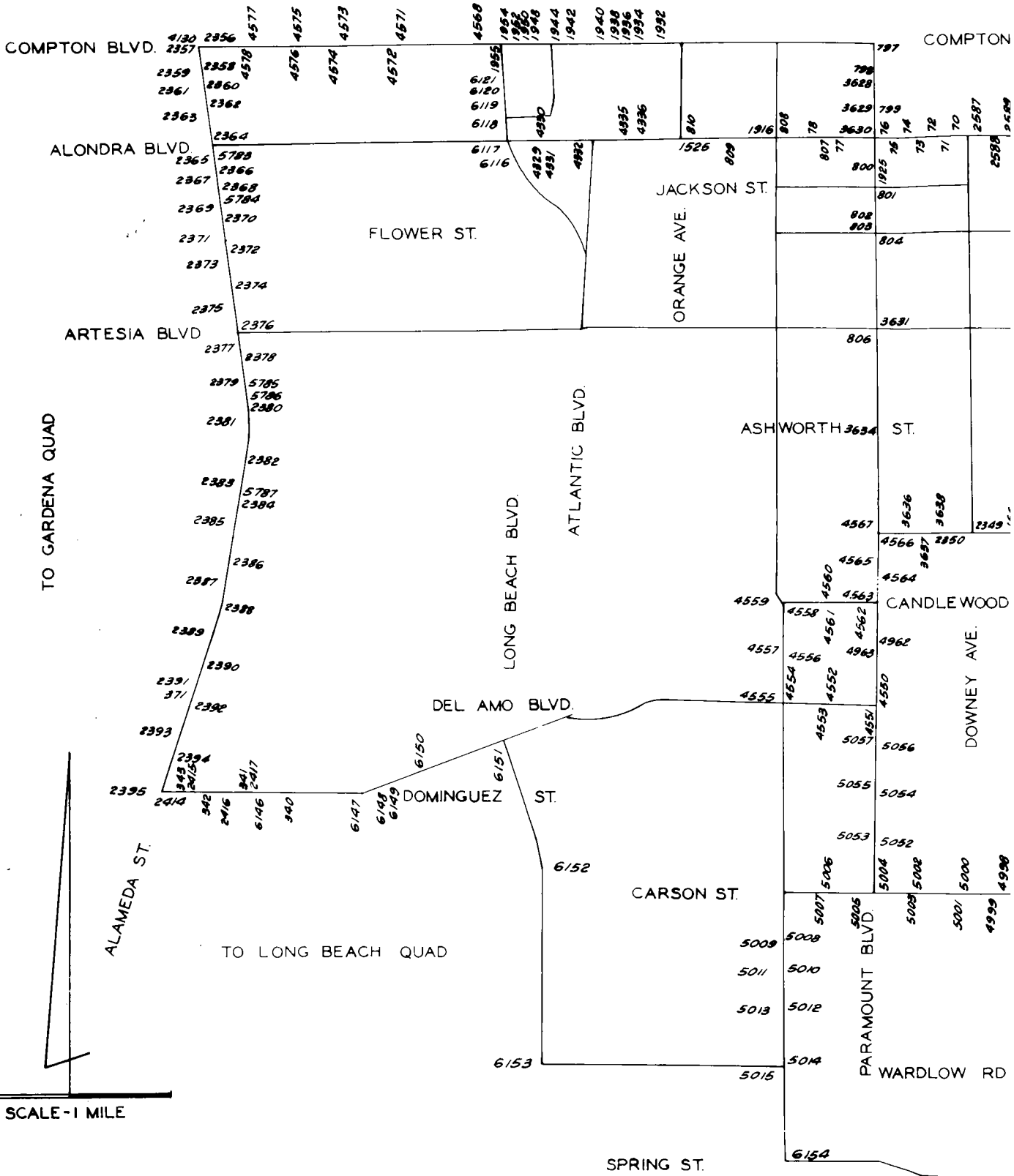

SCALE - 1 MILE

BELLFLOWER QUAD

LOS ANGELES COUNTY ROAD DEPARTMENT
SURVEY SECTION FIELD ENGINEERING DIVISION

TO LONG BEACH

JUL 1964

LOS ANGELES COUNTY ROAD DEPARTMENT
SURVEY SECTION FIELD ENGINEERING DIVISION

PAGE 1

QUAD-YEAR	ELEV	D E S C R I P T I O N (INCLUDE QUAD AND YEAR IN DESCRIPTION)	BM	NUMBER
BASELINE (1955)	66.674	L+T C/L PVMT ALONDRA BLVD 100FT± W C/L DOWNEY AVE	SY	70A
BASELINE (1955)	67.312	L+T C/L INT INDIANA AVE + ALONDRA BLVD	SY	71A
BASELINE (1955)	67.929	CUT SPK 6FT± N C/L INT VIRGINIA AVE + ALONDRA BLVD	SY	72A
BASELINE (1955)	68.528	BT SPK PVMT 7FT± N C/L INT GEORGIA AVE + ALONDRA BLVD	SY	73
BASELINE (1955)	69.048	SPK PVMT 7FT± N C/L INT CRIZABA AVE + ALONDRA BLVD	SY	74A
BASELINE (1955)	68.779	SPK PVMT 8FT± N C/L INT CALIFORNIA AVE + ALONDRA BLVD	SY	75A
BASELINE (1955)	68.751	L+T IN N CB ALONDRA BLVD 15FT± W OF CB RET @ NW COR ALONDRA BLVD + PARAMOUNT BLVD	SY	76E
BELLFLWR (1960)	68.585	L+T PVMT 14FT± S + 19FT± W C/L INT COLORADO AVE + ALONDRA BLVD	SY	77
BELLFLWR (1960)	67.705	L+N E CB VERMONT AVE 63FT± S C/L ALONDRA BLVD	SY	78
BASELINE (1955)	74.665	L+T SW STRADDLER @ C/L INT BELLFLOWER BLVD + CENTER ST	SY	107A
BELLFLWR (1960)	65.298	L+BR T NR CTR CB RET @ SW COR ARTESIA AVE + BELLFLOWER BLVD 5FT± S CTR CB RET	SY	120A
BELLFLWR (1960)	64.070	FC BM 2FT± N CB RET NE COR RAMONA AVE + BELLFLOWER BLVD MKD (74-190)	SY	121A
BELLFLWR (1960)	62.369	L+BN 1FT± N CB RET @ NW COR CEDAR AVE + BELLFLOWER BLVD	SY	122B
BELLFLWR (1960)	60.769	L+SPK 5FT± N CB RET @ NW COR ROSE AVE + BELLFLOWER BLVD	SY	123
BASELINE (1955)	59.644	L+T 1FT± W CB RET @ NW COR ASHWORTH ST + BELLFLOWER BLVD	SY	124
BASELINE (1955)	59.288	RDBM TAG E CB 1FT± N BCR @ NE COR BELLFLOWER BLVD + ASHWORTH ST 56FT± N + 40FT± E C/L INT	SY	125A
BASELINE (1955)	54.326	NWLY OF L+T STRADDLERS NR C/L INT SOUTH ST + LAKEWOOD BLVD	SY	163A
BASELINE (1955)	53.861	L+T W CB 1FT± N CB RET @ NW COR OLIVA AVE + SOUTH ST	SY	164
BASELINE (1955)	53.466	L+T N CB SERVICE RD 2FT± W CB RET @ NW COR CASTANA AVE + SOUTH ST	SY	165
BASELINE (1955)	53.163	L+T N CB SERVICE RD 1FT± W CB RET @ NW COR HAYTER AVE + SOUTH ST	SY	166A
BASELINE (1955)	33.202	L+T CTR CB RET @ SW COR SANTA FE AVE + DOMINGUEZ ST	SY	340A
BASELINE (1955)	31.786	L+SPK 5FT± S CB RET @ SE COR PROSPECT AVE + DOMINGUEZ ST	SY	341A
BASELINE (1955)	31.278	L+T 6FT± S CB RET @ SE COR HARBOR VIEW AVE + DOMINGUEZ ST	SY	342A

JUL 1964

LOS ANGELES COUNTY ROAD DEPARTMENT
SURVEY SECTION FIELD ENGINEERING DIVISION

PAGE 2

QUAD-YEAR	ELEV	DESCRIPTION (INCLUDE QUAD AND YEAR IN DESCRIPTION)	BM NUMBER
BASELINE (1955)	31.931	L+T S CB 30FT± W C/L ALLEY BETWEEN HARBOR VIEW AVE + ALAMEDA BLVD ON DOMINGUEZ ST	SY 343A
BELLFLWR (1955)	.	MADISON ST + PARAMOUNT BLVD	SY 799A
BASELINE (1955)	.	AVE + ALAMEDA BLVD ON DOMINGUEZ ST	SY 343A
BASELINE (1955)	33.022	L+T E HDWL SPRR CULV NO 497.3 25FT± E C/L MAIN TRACK 68FT± W C/L ALAMEDA ST 140FT± N DOMINGUEZ ST	SY 347
BASELINE (1955)	38 ⁷ .795	L+T NW COR SP SIGNAL SWITCH BOX NO 4972 35FT± S C/L DEL AMC BLVD + 25FT± E C/L MAIN LINE SPRR	SY 371A
BASELINE (1955)	65.802	L+T 25FT± W C/L ALAMEDA ST E BARREL ON C/L PROD	SY 2358A
BASELINE (1955)	73.510	CS REF MON IN WELL 14IN DN ON NE COR ALONDRA BLVD + WOODRUFF BLVD 56FT± N + 60FT± E C/L INT MKD (CLEARWATER K 2A)	SY 473A
BASELINE (1955)	74.125	CSBM MON FLUSH ON NE COR ALONDRA BLVD + WOODRUFF AVE 39FT± N + 180FT± W C/L INT MKD (BM 6-6A1958)	SY 474A
BASELINE (1955)	74.844	L+N 80FTS8 S C/L ALONDRA BLVD W CB CORNUTA AVE	SY 475
BASELINE (1955)	75.150	L+N W CB EUCALYPTUS AVE 80FT± S C/L ALONDRA BLVD	SY 476A
BASELINE (1955)	75.083	L+N E CB EUCALYPTUS AVE 80FT± S C/L ALONDRA BLVD	SY 477A
BASELINE (1955)	75.556	L+T E CB LEAHY AVE 80FT± N C/L ALONDRA BLVD	SY 478A
BASELINE (1955)	75.541	L+T W CB LEAHY AVE 80FT± N C/L ALONDRA BLVD	SY 479A
BASELINE (1955)	49.807	SW ONE OF 4 L+T STRADDLERS NR C/L INT STUDEBAKER RD + SOUTH ST	SY 75CA
BASELINE (1955)	51.528	CT SPK CONC PVMT 14FT± S C/L SOUTH ST 85FT± W C/L PALO VERDE AVE	SY 753
BASELINE (1955)	73.092	L+T INT ORCHARD AVE + ALONDRA BLVD	SY 762A
BASELINE (1955)	72.138	L+T 2FT± W CB RET NW COR RYON AVE + ALONDRA BLVD	SY 763A
BASELINE (1955)	74.034	L+BN S CB ALONDRA BLVD 6IN E CB RET @ SE COR ALONDRA BLVD + PACIFIC AVE 70FT± W PERR	SY 765B
BASELINE (1955)	68.914	L + SPK 4FT± E CB RET @ NE COR CLARK AVE + ALONDRA BLVD	SY 766A
BASELINE (1955)	69.941	L+T C/L INT VIRGINIA DR + ALONDRA BLVD	SY 767A
BASELINE (1955)	69.796	L+T C/L INT LAKEWOOD BLVD + ALONDRA BLVD	SY 768
BASELINE (1955)	68.760	L+T C/L INT PITTS AVE + ALONDRA BLVD	SY 769A
BASELINE (1955)	67.894	L+T C/L HAYTER AVE 8FT± S C/L ALONDRA BLVD	SY 770A

QUAD-YEAR	ELEV	DESCRIPTION (INCLUDE QUAD AND YEAR IN DESCRIPTION)	BM NUMBER
BASELINE (1955)	72.955	BT SPK 1FT± S CB RET SE COR PARAMOUNT BLVD + 1ST ST SY	796A
BASELINE (1955)	72.657	CS MON 17FT± W INT PARAMOUNT BLVD + COMPTON BLVD SY	797A
BASELINE (1955)	72.712	L+T CTR CB RET SE COR PARAMOUNT BLVD + ADAMS ST SY	798
BASELINE (1955)	68.962	L+T W CB PARAMOUNT BLVD 2FT± N CB RET @ NW COR <i>MADISON ST + PARAMOUNT BLVD</i> SY	799A
BELLFLWR (1960)	66.768	L+BN W CB PARAMOUNT BLVD 1FT± S CB RET @ SW COR MONROE ST + PARAMOUNT BLVD SY	800A
BELLFLWR (1960)	66.413	SPK NR C/L PARAMOUNT BLVD 28FT± N C/L JACKSON ST SY	801
BELLFLWR (1960)	66.613	L+SPK S CB HARRISON ST 6FT± W CB RET @ SW COR HARRISON ST + PARAMOUNT BLVD SY	802A
BELLFLWR (1960)	66.056	L+T E CB 5FT± N BCR @ NE COR PARAMOUNT BLVD + 70TH ST 57FT± N + 33FT± E C/L INT SY	803A
BELLFLWR (1960)	65.727	CITY OF LONG BEACH MON IN WELL 6IN DN @ CR NR C/L INT PARAMOUNT BLVD + 70TH ST SY	804A
BELLFLWR (1960)	61.289	L+T CTR CB RET 6FT± E L+BRAD @ NW COR ARTESIA ST + PARAMOUNT BLVD SY	806A
BELLFLWR (1960)	67.320	CT SPK CONC PVMT 17FT± S C/L ALONDRA BLVD 35FT± W C/L ILLINOIS ST SY	807
BELLFLWR (1960)	66.712	CT SPK CONC PVMT @ C/L INT ALONDRA BLVD + GARFIELD AVE SY	808A
BELLFLWR (1960)	65.037	BT IN CONC PVMT 14FT± S C/L ALONDRA BLVD CPP HSE NO 7223 SY	809A
BELLFLWR (1960)	65.717	L+BN IN CHIS SQ W CB 25FT± N BCR @ NW COR ORANGE AVE + ALONDRA BLVD 100FT± N + 30FT± W C/L INT MKD (BM) SY	810A
BASELINE (1955)	71.816	L+N NW COR DAIRY PLATFORM 77FT± E C/L STUDEBAKER RD @ HSE NO 16528 SY	832
BASELINE (1955)	65.708	L+N NE COR DAIRY PLATFORM 80FT± W C/L STUDEBAKER RD @ HSE NO 16829 SY	833
BASELINE (1955)	55.184	L+N CB E SIDE STUDEBAKER RD NR N SIDE 4FT WK IN FRONT OF HSE NO 18406 SY	835A
BASELINE (1955)	73.861	L+T S CB ALONDRA BLVD 68FT± W C/L WOODRUFF AVE SY	960A
BASELINE (1955)	77.152	L+T NR S EDGE CONC DRWY 55FT± W C/L WOODRUFF AVE DRWY TO HSE NO 15509 SY	961
BASELINE (1955)	78.775	L+T NR S EDGE N STRIP CONC DRWY 50FT± E C/L WOODRUFF AVE @ HSE NO 15304 SY	962
BELLFLWR (1960)	67.655	L+T 10FT± S CB RET @ SW COR CLARK AVE + LOS ANGELES AVE SY	1425
BELLFLWR (1960)	66.852	L+T 6IN S CB RET @ SW COR CLARK AVE + MAYNE ST SY	1426
BELLFLWR (1960)	65.930	L+T 2FT± S CB RET W SIDE CLARK AVE @ N SIDE RAMONA SCHOOL SY	1427

QUAD-YEAR	ELEV	DESCRIPTION (INCLUDE QUAD AND YEAR IN DESCRIPTION)	BM NUMBER
BELLFLWR (1960)	65.352	L+T 6IN± N BCR @ SW COR CLARK AVE + FLOWER AVE	SY 1429
BELLFLWR (1960)	64.717	L+T 4FT± N CB RET @ NW COR WALNUT AVE + CLARK	SY 1430
BELLFLWR (1960)	63.792	L+T 4FT± N CB RET @ NW COR PARK AVE + CLARK AVE	SY 1431
BELLFLWR (1960)	63.041	L+T 2FT± N CB RET @ NW COR PALM AVE + CLARK AVE	SY 1432
BELLFLWR (1960)	61.624	CS MON IN WELL 8IN DN 6FT± W CB NW COR CLARK AVE + ARTESIA BLVD 67FT± N + 34 FT± W C/L INT MKD (32-2)	SY 1433B
BELLFLWR (1960)	61.727	BR CAP 7FT± S CB RET @ SW COR ARTESIA AVE + CLARK AVE MKD (LA CO FC BM 74-210)	SY 1434
BELLFLWR (1960)	59.893	L+SPK N CB 4FT± E BCR @ NE COR CLARK AVE + ROSE ST 15FT± N + 43FT± E C/L INT MKD (KN 207)	SY 1435A
BELLFLWR (1960)	60.326	L+T 1FT± S CB RET SW COR CEDAR AVE + CLARK AVE	SY 1436
BELLFLWR (1960)	59.693	L+T 2FT± S CB RET SW COR ROSE AVE + CLARK AVE	SY 1437
BASELINE (1955)	58.977	L+T CTR CB RET SW COR ASHWORTH ST + CLARK AVE	SY 1438A
BASELINE (1955)	61.655	L+T S EDGE CONC DRWY 160FT± S + 35FT± W C/L INT STUDEBAKER RD + ARTESIA BLVD NW COR HSE NO 17323	SY 1487
BELLFLWR (1960)	65.735	L+BR @ NW COR ARTESIA AVE + BELLFLOWER BLVD 5FT± W CTR CB RET	SY 1499A
BASELINE (1955)	72.509	L+T CONC PVMT @ C/L INT COMPTON BLVD + COLORADO AVE	SY 1514B
BASELINE (1955)	73.034	L+BN E END GAS ISLAND 75FT± W + 52FT± S C/L INT COMPTON BLVD + VERMONT AVE	SY 1515A
BASELINE (1955)	69.686	L+BN 63FT± E + 52FT± S C/L INT GARFIELD AVE + COMPTON BLVD CONC SERVICE STA YARD	SY 1518
BASELINE (1955)	70.989	L+T W END CONC SLAB 100FT± N + 60FT± E C/L INT GARFIELD AVE + COMPTON BLVD @ FARMER BOYS MKT	SY 1519A
BASELINE (1955)	70.305	L+T W CONC STRIP 53FT± N C/L COMPTON BLVD AT HSE 7243	SY 1520A
BASELINE (1955)	69.747	L+BN N CB COMPTON BLVD 80FT± W C/L INT TEXACO AVE 20FT± N C/L COMPTON BLVD	SY 1521A
BASELINE (1955)	70.528	SPK W CB SAN MARINO AVE 13FT± N BCR @ NW COR SAN MARINO AVE + COMPTON BLVD (MKD KT-5)	SY 1522A
BASELINE (1955)	70.100	L+T E EDGE CONC WK 65FT± E + 40FT± S C/L INT COMPTON BLVD + ORANGE AVE SE COR	SY 1523A
BASELINE (1955)	69.609	L+S W CB ORANGE AVE 13FT± N BCR @ NW COR COMPTON + ORANGE AVE	SY 1524A
BELLFLWR (1960)	64.686	CS MON IN WELL 8IN DN NR C/L ORANGE AVE 100FT± N C/L ALONDRA BLVD MKD (CO SUR RE 329)	SY 1525A
BELLFLWR (1960)	66.864	RDEM TAG N CB 1FT± W BCR @ NW COR ALONDRA BLVD + GARFIELD AVE 40FT± N + 78FT± W C/L INT	SY 1916A

JUL 1964

LOS ANGELES COUNTY ROAD DEPARTMENT
SURVEY SECTION FIELD ENGINEERING DIVISION

PAGE 5

QUAD-YEAR	ELEV	DESCRIPTION (INCLUDE QUAD AND YEAR IN DESCRIPTION)	BM NUMBER
BELLFLWR (1960)	66.163	L+T MCR NE COR PARAMOUNT BLVD + JACKSON ST	SY 1925
BASELINE (1955)	70.014	L+T IN CONC APRON TO BLDG 7002 COMPTON BLVD 45FT± E C/L ORANGE AVE + 35FT± S C/L COMPTON BLVD @ SE COR	SY 1930A
BASELINE (1955)	69.955	L+T W END OF CONC APRON TO BLVD 7000 COMPTON BLVD 25FT± E C/L ORANGE AVE + 45FT± S C/L COMPTON BLVD	SY 1931A
BASELINE (1955)	68.840	L+T W CB EL CAMINO AVE 6FT± N CB RET @ NW COR COMPTON BLVD + EL CAMINO AVE	SY 1932B
BASELINE (1955)	68.955	L+T E CB 15FT± S CB RET @ SE COR FAULKNER AVE + COMPTON BLVD	SY 1933A
BASELINE (1955)	68.922	L+T W CB SAN JOSE AVE 5FT± N CB RET @ NW COR SAN JOSE AVE + 1ST ALLEY N COMPTON BLVD	SY 1934B
BASELINE (1955)	68.763	L+BN W CB SAN JOSE AVE 2FT± N CB RET NW COR SAN JOSE AVE + 1ST ALLEY S COMPTON BLVD	SY 1935B
BASELINE (1955)	68.596	L+T W CB SAN JOSE AVE 8FT± S CB RET @ SW COR SAN JOSE AVE + 1ST ALLEY S COMPTON BLVD	SY 1936A
BASELINE (1955)	67.415	CS MON C/L SAN JOSE AVE + APPROX N P/L OF 1ST ALLEY S COMPTON 130FT± S C/L INT SAN JOSE AVE + COMPTON BLVD	SY 1937B
BASELINE (1955)	69.327	L+T W EDGE CONC APRON TO GARAGE OF HSE 15111 SAN JOSE AVE 135FT± W C/L SAN JOSE AV + 10FT± S C/L 1ST ALLEY S COMPTON BLVD	SY 1938A
BASELINE (1955)	67.099	CS MON @ C/L INT OF COMTON BLVD + SAN ANTONIO AVE IN WELL W/COVER 1FT DEEP STAMPED (RE 329)	SY 1940A
BASELINE (1955)	88.545	RDBM TAG IN EAST ABUT. @ NE COR OF COMPTON BLVD BRIDGE OVER LA RIVER 0.4FT± N OF CB FACE	SY 1941B
BASELINE (1955)	91.909	SET RDBM TAG IN N CB @ CTR PIER OF COMPTON BLVD BRIDGE OVER LA RIVER	SY 1942A
BASELINE (1955)	90.124	RDBM TAG IN WEST ABUT. @ NW COR OF COMPTON BLVD BRIDGE OVER LA RIVER 0.65FT± N OF CB FACE	SY 1943B
BASELINE (1955)	78.240	RDBM TAG IN SOUTH CB COMPTON BLVD 65FT± W OF BRIDGE NO 53-823 OVER THE (LONG BEACH FREEWAY) 250FT± E OF GIBSON AVE	SY 1944B
BASELINE (1955)	68.709	L+T 2FT± N CB RET @ NW COR 1ST ALLEY N COMPTON BLVD ON GIBSON ST	SY 1945B
BASELINE (1955)	67.883	L+T 7FT± S CB RET @ SW COR 1ST ALLEY S COMPTON BLVD ON GIBSON ST	SY 1947B
BASELINE (1955)	67.551	L+T 2.5FT± S CB RET @ SE COR 1ST ALLEY S COMPTON BLVD ON WILLIAMS AVE	SY 1948A
BASELINE (1955)	67.142	CS MON @ C/L INT WILLIAMS AVE + 1ST ALLEY S COMPTON BLVD	SY 1949A
BASELINE (1955)	67.680	L+T S CB COMPTON BLVD 10FT± W CB RET @ SW COR COMPTON BLVD + WILLIAMS AVE	SY 1950A
BASELINE (1955)	68.466	L+T W CB WILLIAMS AVE 20FT± N CB RET @ NW COR WILLIAMS AVE + 1ST ALLEY N COMPTON BLVD	SY 1951A
BASELINE (1955)	67.260	L+T S CB COMPTON BLVD 8FT± W CB RET @ SW COR COMPTON BLVD + FRAILEY AVE	SY 1952A

JUL 1964

LOS ANGELES COUNTY ROAD DEPARTMENT
SURVEY SECTION FIELD ENGINEERING DIVISION

PAGE 6

QUAD-YEAR	ELEV	DESCRIPTION (INCLUDE QUAD AND YEAR IN DESCRIPTION)	BM NUMBER
BASELINE (1955)	66.905	L+SPK S CB COMPTON BLVD 12FT# W CB RET @ SW COR COMPTON BLVD + LIME AVE (SPK MKD T-376)	SY 1953A
BASELINE (1955)	66.900	L+T CTR CB RET @ SE COR COMPTON BLVD + ATLANTIC AVE	SY 1954B
BASELINE (1955)	66.684	LA METRO WATER DIST BR DISC IN CONC SQ 31.3FT# S OF C/L OF COMPTON BLVD 13.3FT# W OF CB RET @ SW COR COMPTON BLVD + ATLANTIC AVE 78FT# SW OF C/L INT MKD (MET WATER DIST 56-W)	SY 1955B
BASELINE (1955)	73.678	L+N SE COR CONC SIGNAL BASE 20FT# S @ C/L COMPTON BLVD W SIDE UPRR	SY 1993A
BASELINE (1955)	69.100	L+T 1FT# S CB RET @ SW COR CENTER ST + LAKEWOOD BLVD	SY 2093A
BASELINE (1955)	71.072	L+BN N CB PACIFIC AVE 65FT# E CB RET @ NE COR PACIFIC AVE + ALONDRA BLVD	SY 2113A
BASELINE (1955)	66.793	L+BN N CB ALONDRA BLVD 1FTS8 W CB RET @ NW COR ALONDRA BLVD + DOWNEY AVE	SY 2342A
BASELINE (1955)	66.864	L+T CTR CB RET @ SE COR ALONDRA BLVD + DOWNEY AVE	SY 2343A
BASELINE (1955)	51.858	L+T CONC WK NR NE COR GAS STATION 8/FT# S + 70FT# W C/L INT DOWNEY AVE + SOUTH ST	SY 2349
BASELINE (1955)	50.128	RDBM TAG S CB 1FT# W FUT BCR @ SE COR SOUTH ST DOWNEY AVE 40FT# S + 57FT# E C/L INT	SY 2350A
BASELINE (1955)	68.972	L+BN N CB COMPTON BLVD 13FT# E OF E RAIL OF SPRR 29FT# W CB RET @ NW COR ALAMEDA ST E DR + COMPTON BLVD 60FT# W C/L E DRIVE 28FT# N C/L COMPTON BLVD	SY 2356A
BASELINE (1955)	69.164	L+BN S CB COMPTON BLVD 5FT# E OF E RAIL OF SPRR 29FT# W CB RET @ SW COR ALAMEDA ST E DR + COMPTON BLVD 70FT# W C/L E DRIVE 28FT# N C/L COMPTON BLVD	SY 2357A
BASELINE (1955)	65.802	L+T 25FT# W C/L ALAMEDA ST E BARREL ON C/L PROD LAUREL ST TO THE E	SY 2358A
BASELINE (1955)	66.197	L+T W CB @ BCR @ NW COR ALAMEDA ST E BARREL + LAUREL ST TO THE W 25FT# W + 32FT# N C/L INT	SY 2359A
BASELINE (1955)	64.431	STEEL SPK WITH (X) ON TOP CTR S BCR TO DRWY OF COMPTON STREET DEPT NO 458 S ALAMEDA ST 29FT# E C/L E BARREL 180FT# N MYRRH ST	SY 2360A
BASELINE (1955)	65.448	CS MON IN WELL 10IN DN 50FT# E C/L SPRR 27FT# W C/L ALAMEDA ST E BARREL + 18FT# S C/L PROD MYRRH ST TO THE E MKD (BM 5-22A)	SY 2361A
BASELINE (1955)	64.997	L+BN W CB ALAMEDA ST E BARREL 12FT# E OF 5TH TELEGRAPH POLE N OF OLIVE ST 530FT# S OF MYRRH ST 25FT# W C/L	SY 2362A
BASELINE (1955)	66.096	L+T IN CB ALONDRA BLVD 20FT# E OF E RAIL OF SPRR 40FT# W C/L ALAMEDA ST E BARREL 30FT# N C/L ALONDRA BLVD	SY 2363A
BASELINE (1955)	65.257	L+T CTR CB RET @ SE COR ALONDRA BLVD + ALAMEDA ST W BARREL 45FT# E C/L W BARREL + 41FT# S C/L ALONDRA BLVD	SY 2364A
BASELINE (1955)	63.023	L+T E CB ALAMEDA ST C/L PROD RAYMOND AVE 27FT# E C/L ALAMEDA ST	SY 2365A

QUAD-YEAR	ELEV	DESCRIPTION (INCLUDE QUAD AND YEAR IN DESCRIPTION)	BM NUMBER
BASELINE (1955)	62.777	L+T E CB ALAMEDA ST C/L PROD REEVE ST	SY 2366A
BASELINE (1955)	62.408	L+T E CB ALAMEDA ST C/L PROD TICHNOR ST	SY 2367A
BASELINE (1955)	62.130	L+T E CB ALAMEDA ST C/L PROD CALDWELL ST 26FT± E C/L ALAMEDA ST	SY 2368A
BASELINE (1955)	61.826	L+T E ALAMEDA ST C/L PROD JOHNSON ST	SY 2369A
BASELINE (1955)	61.518	L+T E CB ALAMEDA ST C/L PROD BENNETT ST TO THE W	SY 2370A
BASELINE (1955)	60.757	L+BN E CB ALAMEDA ST OPP MILE POST NO 495 SPRR	SY 2373A
BASELINE (1955)	60.279	STD DISC TOP OF CONC POST 3FT± N OF MILE POST NO 495 SPRR + 38FT± E C/L SPRR 2FT± BELOW TOP OF RAIL MKD (Q 768 1945)	SY 2374A
BASELINE (1955)	59.741	L+BN E CB ALAMEDA ST OPP PP NO 1328507E W SIDE SPRR + 4TH TP N OF ARTESIA AVE	SY 2375A
BASELINE (1955)	63.442	L+BN E CB ALAMEDA ST @ ANGLE POINT OF WINGWALL @ NE COR BRIDGE NO 774 OVER COMPTON CREEK 22FT± E C/L + 174FT± N C/L CREEK + 400FT± S ARTESIA BLVD	SY 2377A
BASELINE (1955)	58.668	FC BR CAP @ S END OF WINGWALL @ NE COR SPRR BRIDGE 90FT± E C/L ALAMEDA ST + 450FT± S C/L ARTESIA BLVD MKD (RBM 44-33)	SY 2378A
BASELINE (1955)	63.474	FC BR CAP 5FT± S ANGLE POINT WINGWALL SW COR BRIDGE NO 774 ON ALAMEDA ST OVER COMPTON CREEK 28FT± W C/L + 600FT± S ARTESIA BLVD MKD (BM 44-33)	SY 2379A
BASELINE (1955)	52.041	FC BR CAP E CB ALAMEDA ST 22FT± E C/L OPP MAIN ENT DOMINQUEZ SEMINARY 0.25MI± N DOMINQUEZ JCT 18FT± S PP NO 241560E MKD (RBM 44-32)	SY 2380A
BASELINE (1955)	53.343	FC BR CAP SE COR 8X8FT CONC VALVE BOX 58FT± E C/L SPRR + 125FT± E C/L ALAMEDA ST OPP MAIN ENT TO DOMINQUEZ SEMINARY MKD (BM 44-32)	SY 2381A
BASELINE (1955)	51.101	L+BN W CB ALAMEDA ST 22FT± W C/L OPP NE COR 8FT CHAIN LINK FENCE AROUND SO CAL EDISON SUB-STATION PROPERTY 650FT± N DOMINGUEZ JCT	SY 2382A
BASELINE (1955)	51.999	CS MON IN CONC FLUSH APPROX C/L PERR TRACTS 50FT± W C/L ALAMEDA ST 56FT± N OF N COR DOMINGUEZ JCT STA HSE BET ARTESIA BLVD + DEL AMO BLVD MKD (K-5 RE 2177 1942)	SY 2383A
BASELINE (1955)	47.192	L+BN W CB ALAMEDA ST 22FT± W C/L + 530FT± S C/L LONG BEACH LINE PERR 37FT± N TP NO 16767R	SY 2384A
BASELINE (1955)	46.369	L+BN E CB ALAMEDA ST 22FT± E C/L + 1630FT± S C/L LONG BEACH LINE PERR 47FT± S TP NO 662675H	SY 2385A
BASELINE (1955)	44.715	L+BN E CB ALAMEDA ST 2 BARREL 22FT± E C/L 3FT± S TP NO 46810CH 2630FT± S C/L LONG BEACH LINE PERR	SY 2386A
BASELINE (1955)	43.410	L+T E CB ALAMEDA ST W BARREL 22FT± E C/L 3FT± S TP NO 4469US 0.5MI± N DEL AMO BLVD	SY 2387A

JUL 1964

LOS ANGELES COUNTY ROAD DEPARTMENT
SURVEY SECTION FIELD ENGINEERING DIVISION

PAGE 8

QUAD-YEAR	ELEV	D E S C R I P T I O N (INCLUDE QUAD AND YEAR IN DESCRIPTION)	BM NUMBER
BASELINE (1955)	43.403	STD USGS DISC IN CONC POST 3IN UP 30FT± E C/L SPRR 55FT± W C/L ALAMEDA ST E BARREL OPP BLDG NO 19600 (WOLF RANGE CORP) 4FT± N TP NO LU 2FT± W OF WHITE WOODEN WITNESS POST MKD (P768 1945)	SY 2388A
BASELINE (1955)	41.859	L+BN E CB ALAMEDA ST W BARREL 22FT± E C/L 3FT± S OF TP NO 429291H OPP BLDG NO 19722	SY 2389A
BASELINE (1955)	41.348	CUT SPK E CB ALAMEDA ST W BARREL 22FT± E C/L 1FT± W OF TP NO 457450H C.25MI± N OF DEL AMO BLVD	SY 2390A
BASELINE (1955)	34.332	CS MON IN WELL 2FT± N C/L DEL AMO BLVD @ APPROX C/L OF 2 SETS OF PERR TRACKS W ALAMEDA ST W BARREL MKD (COMP J-7 1942 RE 2177)	SY 2391A
BASELINE (1955)	38.192	L+T E CB 2FT± S OF END OF CB @ SE COR ALAMEDA ST W BARREL + DEL AMO BLVD 4FT± N TP NO 427134H 65FT± S + 22FT± E C/L INT	SY 2392A
BASELINE (1955)	33.128	L+SPK E CB ALAMEDA ST W BARREL 22FT± E C/L 48FT± N PP NO 577434 1400FT± S DEL AMO BLVD	SY 2393A
BASELINE (1955)	32.557	L+BN E CB ALAMEDA ST W BARREL 22FT± E C/L 23FT± PP NO 577803R 900FT± N OF DOMINGUEZ ST	SY 2394A
BASELINE (1955)	33.488	L+BN S CB TRAFFIC ISLAND @ NW COR ALAMEDA ST + DOMINGUEZ ST (HALF WAY BETWEEN SPRR + PERR)	SY 2395A
BASELINE (1955)	32.116	L+T MCR @ SE COR ALAMEDA ST + DOMINGUEZ ST	SY 2414A
BASELINE (1955)	31.764	L+T S CB DOMINGUEZ ST 1FT± W DRWY HSE NO 2638 DOMINGUEZ ST	SY 2415A
BASELINE (1955)	32.405	L+T S CB DOMINGUEZ ST 25FT± W DRWY HSE NO 2738 DOMINGUEZ ST (FRONT FIRE PLUG)	SY 2416A
BASELINE (1955)	33.268	L+SPK W CB SANTA FE AVE 3FT± S CB RET @ SW COR DOMINGUEZ ST + SANTA FE AVE	SY 2417A
BASELINE (1955)	65.246	C S MON 30FT± N + 80FT± E C/L INT ALONDRA BLVD + DOWNEY AVE 6FT± E OF CATCH BASIN	SY 2587
BASELINE (1955)	66.664	L+T NR W ED OF CONC WK 20FTS8 E OF BLDG NO 8549 ALONDRA BLVD 55FT± N OF C/L ALONDRA BLVD (WSIDE OF DRIVE ENT TO BURGE + GRAY MATERIALS CO YARD) 6FT± N OF BEG OF WK	SY 2588A
BASELINE (1955)	67.839	L+T NR W ED OF CONC WK AROUND HSE NO 8700 ALONDRA BLVD 57FT± S + 25FT± E C/L INT ALONDRA BLVD + HAYTER ST	SY 2589
BASELINE (1955)	69.866	L+T SE COR CONC APRON IN FRONT OF BLDG NO 9161 ALONDRA BLVD 85FT± N C/L ALONDRA BLVD 31FT± W C/L VIRGINIA DR	SY 2593A
BASELINE (1955)	69.045	SPK N EDGE CONC PVMT 22FT± N C/L ALONDRA BLVD 23FT± E TP NO M-1173-Y 10FT± W C/L SANTA ANA AVE 600FT± W CLARK AVE MKD (ML33)	SY 2595A
BASELINE (1955)	67.729	CS MON 30FT± N + 70FT± E C/L INT ALONDRA BLVD + CLARK AVE 6FTS8 S OF N CB + 20FT± E OF CB RET @ NE COR ALONDRA MKD (BM 6-8 RE NO 63-1951)	SY 2596A
BASELINE (1955)	73.636	L+T N CB 4FT± W CB RET @ NW COR ALONDRA BLVD + BLAINE AVE	SY 2597A
BASELINE (1955)	73.780	L+T N CB 2FT± E CB RET @ NE COR ALONDRA BLVD + BLAINE AVE	SY 2598

JUL 1964

LOS ANGELES COUNTY ROAD DEPARTMENT
SURVEY SECTION FIELD ENGINEERING DIVISION

PAGE 9

QUAD-YEAR	ELEV	DESCRIPTION (INCLUDE QUAD AND YEAR IN DESCRIPTION)	BM NUMBER
BELLFLWR (1955)	74.086	L+BN CB W OF BELLFLOWER WATER CO PLANT NO 1 10FT# S OF S CB ALONDRA BLVD + 18FT# E C/L BLAINE AVE PROD	SY 2599A
BASELINE (1955)	74.479	L+BN S CB 1FT# W CB RET @ SW COR ALONDRA BLVD + BELLFLOWER BLVD	SY 2600
BASELINE (1955)	75.177	L+B NW CB 10FT# S CB RET SW COR EUCALYPTUS AVE + ALONDRA BLVD	SY 2602A
BASELINE (1955)	92.444	CO FLOOD CONTROL BR DISC IN SW COR BRIDGE NO B977 OVER SAN GABRIEL RIV 25FT# C/L ALONDRA BLVD MKD (BM 75-46)	SY 2611A
BASELINE (1955)	89.640	CORP OF ENGINEERS BR DISC IN SE COR BRIDGE NO B977 OVER SAN GABRIEL RIV 25FT S C/L ALONDRA BLVD MKD (SG 18 1958)	SY 2612A
BASELINE (1955)	72.464	L+T NW COR OF CONC DRWY HSE NO 10658 ALONDRA BLVD 45FT# S C/L 2ND HSE E OF BRIDGE OVER SAN GABRIEL RIV	SY 2613A
BASELINE (1955)	72.475	L+T N CB 1FT# E CB RET @ NE COR ALONDRA BLVD SERVICE RD + PIUMA AVE	SY 2614
BASELINE (1955)	72.954	L+T N CB @ CB RET NE COR ALONDRA BLVD SERVICE RD + BEHRENS AVE	SY 2615
BASELINE (1955)	73.422	L+T N CB 1FT# E CB RET @ NE COR ALONDRA BLVD SERVICE RD + DUMONT AVE	SY 2616A
BASELINE (1955)	73.948	L+T N CB 1FT# E OF CB RET @ NE COR ALONDRA BLVD SERVICE RD + LEIBACHER AVE	SY 2617A
BASELINE (1955)	72.813	CS REF MON IN WELL 9IN DN DN NW COR STUDEBAKER RD + ALONDRA BLVD 56FT# N + 62FT# W C/L INT MKD (ARTESIA A-2 NO 3 1960)	SY 2618A
BASELINE (1955)	73.258	CS REF MON IN WELL 9IN DN DN NE COR STUDEBAKER RD + ALONDRA BLVD 85FT# N + 50FT# E C/L INT MKD (ARTESIA A-2 NO 4 1960)	SY 2619A
BASELINE (1955)	61.574	BT SPK CTR HDWL ON NE COR ARTESIA BLVD + STUDEBAKER RD 41FT# W 19FT# E C/L INT	SY 2646A
BASELINE (1955)	44.597	L+BN N CB CARSON ST @ NE COR CARSON ST + 1ST ALLEY W OF WOODRUFF AVE 1FT# E CB RET	SY 2678A
BASELINE (1955)	45.107	L+T N CB CARSON ST @ NW COR CARSON ST + WOODRUFF AVE 2FT# W CB RET	SY 2679A
BELLFLWR (1960)	41.320	L+T W CB 1FT# N CB RET @ NW COR WOODRUFF AVE + HARCO ST	SY 2681A
BELLFLWR (1960)	40.898	L+T W CB 1FT# S CB RET @ SW COR WOODRUFF AVE + HARCO ST	SY 2682A
BELLFLWR (1960)	36.029	L+T W CB 1FT# N CB RET @ NW COR WOODRUFF AVE + CONANT ST	SY 2683A
BELLFLWR (1960)	35.090	RD MON @ C/L INT CONANT ST + WOODRUFF AVE	SY 2684A
BELLFLWR (1960)	35.546	L+T W CB 1FT# S CB RET @ SW COR CONANT ST + WOODRUFF AVE	SY 2685A
BELLFLWR (1960)	32.781	L+T W CB SERVICE RD 1FT# N CB RET @ NW COR MONLACO RD + WOODRUFF AVE	SY 2686A

QUAD-YEAR	ELEV	DESCRIPTION (INCLUDE QUAD AND YEAR IN DESCRIPTION)	BM NUMBER
BELLFLWR (1960)	32.049	RD MON @ C/L INT MONLACO RD + WOODRUFF AVE	SY 2687A
BELLFLWR (1960)	29.907	L+T W CB WOODRUFF AVE (SERVICE RD) 1FT# S CB RET @ SW COR PARAPET ST + WOODRUFF AVE	SY 2688A
BELLFLWR (1960)	28.098	L+T CTR CB RET PKWY TO THE W IN CTR WARDLOW RD 95FT# W C/L WOODRUFF AVE	SY 2690A
BELLFLWR (1960)	28.517	L+BN S CB S DRIVE 1FT E CB RET @ SE COR GCANA AVE + WARDLOW RD	SY 2691B
BELLFLWR (1960)	28.743	L+T N CB N DRIVE 1FT# E CB RET @ NE COR SAN ANSELINE AVE + WARDLOW RD	SY 2692B
BELLFLWR (1960)	29.462	L+T N CB N DRIVE 1FT# E CB RET @ NE COR CHATWIN AVE WARDLOW RD	SY 2693B
BELLFLWR (1960)	28.618	L+T N CB N DRIVE 1FT# E CB RET SERVICE RD BELLFLOWER BLVD @ NE COR WARDLOW RD + BELLFLOWER BLVD SERVICE RD	SY 2694B
BELLFLWR (1960)	28.836	L+T W CB W SERVICE RD BELLFLOWER BLVD 1FT# N CB RET @ NW COR WARDLOW RD + BELLFLOWER BLVD	SY 2695B
BELLFLWR (1960)	31.262	L+N W CB BELLFLOWER BLVD 1FT# N CB RET @ NW COR W SERVICE RD BELLFLOWER BLVD + MONLACO RD	SY 2696A
BELLFLWR (1960)	32.060	L+N W CB W SERVICE RD BELLFLOWER BLVD 1FT# N CB RET @ NW COR W SERVICE RD BELLFLOWER BLVD + KEYNOTE ST	SY 2697A
BELLFLWR (1960)	32.865	L+N W CB W SERVICE RD TO BELLFLOWER BLVD 1FT# N CB RET @ NW COR W SERVICE RD BELLFLOWER BLVD + PEABODY ST	SY 2698A
BELLFLWR (1960)	34.290	RD MON @ C/L INT BELLFLOWER BLVD + CONANT ST	SY 2699A
BELLFLWR (1960)	34.615	L+T CTR CB RET @ NW COR BELLFLOWER BLVD + CONANT ST	SY 2700A
BELLFLWR (1960)	36.829	L+T E CB 1FT# N CB RET @ SE COR BELLFLOWER BLVD + HARCO ST	SY 2701A
BELLFLWR (1960)	36.889	L+PK N CB (CB IN APRON OF DRWY HSE NO 5505 HARCO ST) 1FT# E CB RET @ NE COR BELLFLOWER BLVD + HARCO ST	SY 2702A
BELLFLWR (1960)	38.318	L+PK S CB PARKCREST ST 1FT# W BELLFLOWER BLVD + PARKCREST ST	SY 2703
BASELINE (1955)	40.335	RDBM TAG S CB 1FT# W BCR @ SW COR BELLFLOWER BLVD + CARSON ST 38FT# S + 70FT# W C/L INT	SY 2704A
BASELINE (1955)	40.317	L+T @ CTR CB RET @ NE COR BELLFLOWER BLVD + CARSON ST	SY 2706A
BASELINE (1955)	22.488	L+BN S CB SPRING ST 1FT# E CB RET @ SE COR SPRING ST + PALO VERDE AVE	SY 293CA
BASELINE (1955)	21.800	CS MON (BR SPK IN CONC) @ INT PALO VERDE AVE + SPRING ST 18IN DN	SY 2931A
BASELINE (1955)	22.204	L+BN S CB ADDERLEY DR 13FT# W DRWY HSE NO 5844	SY 2936
BELLFLWR (1960)	23.328	L+BR NE CB S SERVICE RD WOODRUFF AVE ON C/L PROD ADDERLEY DR	SY 2937

QUAD-YEAR	ELEV	DESCRIPTION (INCLUDE QUAD AND YEAR IN DESCRIPTION)	BM NUMBER
BELLFLWR (1960)	23.445	L+BN N CB LOS COYOTES BLVD 4FT± E CB RET 94FT± E SY + 40FT± N C/L INT WOODRUFF AVE + LOS COYOTES BLVD	2938
BELLFLWR (1960)	23.168	L+BN NW CB LOS COYOTES BLVD 15FT± NE CATCH BASIN SY OPP HSE NO 3127 (SE CB OF PKWY)	2939
BASELINE (1955)	21.382	CS MON 8FT± S C/L SPRING ST (N SERVICE RD) 15FT± SY E C/L LOMINA AVE PROD	2940
BASELINE (1955)	22.931	L+N S CB SPRING ST (N SERVICE RD) C/L LOMINA AVE SY PROD	2941
BASELINE (1955)	22.197	L+N CTR CB RET S END PARKWAY OF SAN ANSELINA AVE SY + SPRING ST SERVICE RD	2942A
BASELINE (1955)	23.054	L+N S CB SPRING ST N SERVICE RD + CHATWIN AVE SY PROD	2943
BASELINE (1955)	22.677	L+BN N CB SPRING ST 1FT± E CB RET @ NE COR SY SPRING ST + BELLFLOWER BLVD	2944
BASELINE (1955)	22.109	L+BN N CB SPRING ST 1FT± W CB RET @ NW COR SY SPRING ST + BELLFLOWER BLVD	2945
BASELINE (1955)	21.755	CS MON INT SPRING ST + BELLFLOWER BLVD N EDGE SY	2946
BASELINE (1955)	71.246	L+N IN CONC CB 13FT± W DAIRY PLATFORM 100FT± S SY HSE NO 16404 STUDEBAKER RD 70FT± E C/L	3371
BASELINE (1955)	69.933	CS MON 5FT E C/L STUDEBAKER RD 5FT S C/L 166TH SY ST 10IN DEEP	3372A
BASELINE (1955)	62.955	L+T DRWY HSE NO 17121 STUDEBAKER RD 50FT± W C/L SY 1FT± IN FROM N EDGE OF DRWY	3373A
BASELINE (1955)	57.778	L+T E EDGE CONC WK TO HSE NO 17907 STUDEBAKER RD SY 35FT± W C/L	3376A
BASELINE (1955)	55.836	CS MON 100FT N C/L 183RD ST + 5FT E C/L SY STUDEBAKER RD	3377A
BASELINE (1955)	55.963	CS MON W/CASE + COVER @ C/L INT STUDEBAKER RD + SY 183RD ST	3378A
BASELINE (1955)	53.542	L+T N EDGE CONC DRWY TO HSE NO 18810 50FT± E C/L SY STUDEBAKER RD	3379
BASELINE (1955)	51.599	L+T 1FT± BACK FROM END OF CONC WK TO HSE NO SY 10969 SOUTH ST @ NW COR STUDEBAKER RD + SOUTH ST	3380
BASELINE (1955)	70.831	L+BN W CB PARAMOUNT BLVD 1FT N CB RET @ NW COR SY JEFFERSON ST + PARAMOUNT BLVD	3628A
BASELINE (1955)	67.869	CS MON 16FT± W C/L PARAMOUNT BLVD 150FT± S C/L SY MADISON ST MKD (LACS CON SYS TRI STA CLEARWATER E-Z RE 21771938)	3629
BASELINE (1955)	68.353	L+BN IN N CB 1FT± E BCR @ NE COR ALONDRA BLVD + SY PARAMOUNT BLVD 40FT± N + 48FT± E C/L INT	3630A
BELLFLWR (1960)	61.320	L+BN CTR CB RET @ SW COR ARTESIA ST + PARAMOUNT SY BLVD	3631A
BELLFLWR (1960)	52.835	L+BN E SIDE CONC BASE S GATE POST OF WIRE FENCE SY 45FT± W C/L PARAMOUNT BLVD 6FT± NE COR EDISON CO TRANSFORMER ON THE RICHFIELD CIL CO PROPERTY 5900 BLOCK OF PARAMOUNT BLVD	3634

QUAD-YEAR	ELEV	DESCRIPTION (INCLUDE QUAD AND YEAR IN DESCRIPTION)	BM NUMBER
BASELINE (1955)	50.732	L+T E CB DRIZABA AVE 1FT± S CB RET @ SE COR DRIZABA AVE + SOUTH ST	SY 3636
BASELINE (1955)	51.203	L+T E CB OBISPO AVE 1FCTS± CB RET NE COR OBISPO AVE + SOUTH ST	SY 3637
BASELINE (1955)	51.849	L+T W END 2ND STEP OF BLDG NO 3109 SOUTH ST 85FT± E OBISPO AVE	SY 3638
BASELINE (1955)	54.463	L+BN N CB SOUTH ST 1FT± W CB RET @ NW COR LAKEWOOD BLVD + SOUTH ST	SY 3639A
BASELINE (1955)	53.835	L+BN S CB SOUTH ST 1FT± E CB RET @ SE COR LAKEWOOD BLVD + SOUTH ST	SY 3640A
BELLFLWR (1960)	64.098	L+B CTR CB RET @ NW COR BIXBY AVE TO RAMONA ST (@ SE COR OF LARGE ISLAND)	SY 3669
BASELINE (1955)	57.088	L+BN S CB ALLINGTON ST 75FT± W C/L WOODRUFF AVE	SY 3676
BELLFLWR (1960)	59.327	L+T S CB DRWY TO HSE NO 6104 CARPINTERO AVE @ NE COR ALLINGTON ST CARPINTERO AVE 35FT± E C/L CARPINTERO AVE	SY 3678
BASELINE (1955)	57.247	L+BR W CB 3FT± N BCR @ NW COR ALLINGTON ST + CANEHILL AVE 75FT± N + 18FT± W C/L INT	SY 3679A
BASELINE (1955)	57.802	RDEM TAG S CB 1FT± E BCR @ SE COR ALLINGTON ST + CANEHILL AVE 30FT S + 60FT± E C/L INT	SY 3680A
BASELINE (1955)	56.305	CS MON C/L INT PALO VERDE AVE + ALLINGTON ST	SY 3681
BELLFLWR (1960)	58.382	L+BN NW CONC FOOTING TOWER NO 4-3 NW COR ALLINGTON ST (183RD ST) + MARMALADE ST 190FT± N + 125FT± W C/L INT	SY 3682A
BELLFLWR (1960)	57.995	RDEM TAG NW COR CONC SLAB OF HAY PLATFORM ON SE COR 183RD ST + MARMALADE ST 22FT± S 140FT± E C/L INT	SY 3683A
BASELINE (1955)	56.526	L+T NW COR LOADING PLATFORM DAIRY BARN 65FT± S HSE NO 5810 PALO VERDE AVE 50FT± E C/L PALO VERDE AVE	SY 3684
BASELINE (1955)	52.178	L+T CONC WK @ SW COR HSE NO 6405 NE COR PALO VERDE AVE + SOUTH ST	SY 3685
BASELINE (1955)	50.152	CS MON 88FT± S C/L SOUTH ST 9FT± E C/L PALO VERDE AVE	SY 3686
BASELINE (1955)	66.415	FC BR CAP @ E END BRIDGE OVER THE SAN GABRIEL RIV ON SOUTH ST @ SE COR OF BRIDGE BM 74-54	SY 3687
BASELINE (1955)	71.010	L+T @ W END OF BRIDGE OVER SAN GABRIEL RIV ON S SOUTH ST @ SW COR BRIDGE ON S CB	SY 3688
BASELINE (1955)	58.531	L+T 1FT± S CB RET @ SW COR ASHWORTH ST + WOODRUFF AVE	SY 3702
BELLFLWR (1960)	59.788	L+T 1FT± S CB RET @ SW COR ROSE ST + WOODRUFF AVE	SY 3703
BELLFLWR (1960)	59.900	L+T 1FT± N CB RET @ NW COR ROSE ST + WOODRUFF AVE	SY 3704
BELLFLWR (1960)	62.670	RAM SET S CB 2FT± E BCR @ SW COR WOODRUFF AVE + ARTESIA BLVD 40FT± S + 73FT± W C/L INT	SY 3705A

QUAD-YEAR	ELEV	D E S C R I P T I O N (INCLUDE QUAD AND YEAR IN DESCRIPTION)	BM NUMBER
BASELINE (1955)	66.063	CS MON IN WELL 4FT± E OF W CB ALAMEDA ST E BARREL 24FT± W C/L ALAMEDA ST E BARREL + 48FT± N C/L COMPTON BLVD MKD (BM 5-21 RE 329 1951)	SY 4130A
BASELINE (1955)	68.527	CS MON 14FT± N C/L COMPTON BLVD + 57FT± E C/L ORANGE AVE IN WELL W/COVER 10IN DEEP MKD (BM 6-15 1951 RE 63)	SY 4323A
BELLFLWR (1960)	63.540	CS MON IN WELL W/COVER 12IN DN @ C/L INT 1ST ALLEY N ALONDRA BLVD ON FRAILEY AVE	SY 4329
BELLFLWR (1960)	64.556	L+T E CB FRAILEY AVE 1FT± N CB RET 1ST ALLEY N ALONDRA BLVD	SY 4330
BELLFLWR (1960)	82.392	FC BR DISC E ABUT BRIDGE B-1132 OVER LA RIV 46FT± N C/L ALONDRA BLVD MKD (BM 4-23)	SY 4331A
BELLFLWR (1960)	75.300	L+BN CONC FACE E LEVEE LA RIV 200FT± N C/L ALONDRA BLVD + 212FT± E C/L LA RIV 1FT± FROM EDGE OF CONC	SY 4332
BELLFLWR (1960)	64.739	L+BN W CB HUNSAKER AVE 40FT± W + 134FT± N C/L INT ALONDRA BLVD + HUNSAKER AVE	SY 4335
BELLFLWR (1960)	65.315	RDBM TAG N CB 1FT± E BCR @ NE COR ALONDRA BLVD + HUNSAKER AVE 70FT± N + 101FT± E C/L INT	SY 4336A
BASELINE (1955)	47.802	L+BR 3FT± W CB RET @ SW COR PARAMOUNT BLVD + DEL AMO BLVD	SY 4550
BASELINE (1955)	46.917	CS MON IN WELL 37FT± N C/L DEL AMO BLVD 70FT± W C/L PARAMOUNT BLVD 2FT± N OF CB FLUSH W/WLK	SY 4551
BELLFLWR (1960)	57.175	RDBM TAG N CB DEL AMO BLVD 40FT± E C/L UPRR	SY 4552
BELLFLWR (1960)	57.079	RDBM TAG S CB DEL AMO BLVD 75FT± E C/L UPRR	SY 4553
BELLFLWR (1960)	56.386	RDBM TAG 1FT± N CB RET @ NW COR CHERRY AVE + DEL AMO BLVD	SY 4554
BELLFLWR (1960)	56.783	L+T S CB DEL AMO BLVD 100FT± W CB RET @ SW COR CHERRY AVE + DEL AMO BLVD	SY 4555A
BELLFLWR (1960)	49.689	L+T NW COR 3FT BY 3FT CONC BASE OF 16IN STEEL VENT 100FT± W C/L CHERRY AVE 20FT± S C/L 52ND ST	SY 4556
BELLFLWR (1960)	49.082	L+T E CB CHERRY AVE 70FT± N C/L 52ND ST PROD	SY 4557
BELLFLWR (1960)	46.959	CS MON IN WELL 16IN DN C/L MARKET ST PROD 30FT± E C/L CHERRY AVE (ALSO C/L CHERRY AVE PROD FROM SOUTH)	SY 4558
BELLFLWR (1960)	48.618	L+T W CB CHERRY AVE 1FT± N CB RET @ NW COR MARKET ST + CHERRY AVE	SY 4559
BELLFLWR (1960)	50.057	L+T 20FT± W SE COR (OIL PUMP STATION) CONC FOOTING OF WIRE FENCE 60FT± W UPRR TRACK (TO S) 120FT± N C/L CANDLEWOOD ST PROD 400FT± S (DOUGLAS JUNCTION) UPRR	SY 4560
BELLFLWR (1960)	55.441	L+T N CB CANDLEWOOD ST 2FT± E CB RET WIDE ALLEY + 25FT± E C/L PROD DEBOYAR AVE	SY 4561
BASELINE (1955)	48.923	L+T S CB CANDLEWOOD ST 7FT± E C/L PROD 1ST ALLEY W OF PARAMOUNT BLVD	SY 4562

QUAD-YEAR	ELEV	DESCRIPTION (INCLUDE QUAD AND YEAR IN DESCRIPTION)	BM NUMBER
BASELINE (1955)	48.833	RDBM TAG 15FT± S CB RET @ NW COR PARAMOUNT BLVD + CANDLEWOOD ST	SY 4563
BASELINE (1955)	52.048	L+T NR E EDGE CONC WK 36FT± S C/L 55TH WAY + 105FT± E C/L PARAMOUNT BLVD S OF END OF WK	SY 4564
BASELINE (1955)	50.383	L+T NR SE COR CONC SLAB @ ENT BLDG NO 5584 PARAMOUNT BLVD 60FT± E C/L PARAMOUNT BLVD + 105FT± S C/L 56TH ST	SY 4565
BASELINE (1955)	52.069	L+T NR CTR CB RET @ SW COR SOUTH ST + PARAMOUNT BLVD	SY 4566
BASELINE (1955)	51.443	RDBM TAG 1.5FT± E BCR @ NE COR PARAMOUNT BLVD + SOUTH ST 40FT± N + 75FT± E C/L INT	SY 4567
BASELINE (1955)	67.575	L+SPK N CB COMPTON BLVD 10FT± E C/L WHITE AVE PROD MKD (T-373)	SY 4568A
BASELINE (1955)	67.987	L+SPK 3FT± E CB RET @ SE COR COMPTON BLVD + BRADFIELD AVE	SY 4571A
BASELINE (1955)	66.492	CITY OF COMPTON MON IN WELL 18IN DP C/L COMPTON BLVD + C/L PROD BRADFIELD AVE N	SY 4572A
BASELINE (1955)	66.754	CITY OF COMPTON MON IN WELL 12IN DP @ C/L INT COMPTON BLVD + LONG BEACH BLVD 5FT± N OF MON TO THE S	SY 4574A
BASELINE (1955)	67.086	RDBM TAG E CB BURRIS AVE 15FT± N CB RET @ NE COR COMPTON BLVD	SY 4575A
BASELINE (1955)	66.639	L+T 15FT± S CB RET W CB BURRIS AVE @ SW COR COMPTON BLVD	SY 4576A
BASELINE (1955)	64.917	L+SPK CTR CB RET @ SE COR SANTA FE AVE + COMPTON BLVD	SY 4577A
BASELINE (1955)	65.180	L+SPK 1FT± N CB RET @ NE COR SANTA FE AVE + COMPTON BLVD	SY 4578A
BASELINE (1955)	58.109	CS MON IN WELL 8IN DN ON SW COR CLARK AVE + ASHWORTH ST 38FT S + 30FT W C/L INT MKD (BM 32 3)	SY 4961
BASELINE (1955)	47.116	RDBM TAG W CB 6FT N BCR OF ISLAND @ NW COR PARAMOUNT BLVD + HARDWICK ST 45FT N + 40FT W C/L INT	SY 4962
BASELINE (1955)	47.278	RDEM TAG W CB 2FT S BCR OF ISLAND @ SW COR PARAMOUNT BLVD + HARDWICK ST 37FT S + 43FT W C/L INT	SY 4963
BASELINE (1955)	44.963	RDEM TAG W CB 3FT± N BCR @ NW COR LAKEWOOD BLVD + CARSON ST 67FT± N + 45FT± W C/L INT	SY 4978
BASELINE (1955)	45.518	RDBM TAG N CB 36FT± W BCR @ NW COR LAKEWOOD BLVD + CARSON ST 45FT± N + 100FT± W C/L INT	SY 4979
BASELINE (1955)	38.770	USC+GS BR CAP NR S END E ABUT CONC BRIDGE 50FT± S C/L CARSON ST + 500FT± E CLARK AVE MKD (E 780 RESET 1953)	SY 4996
BASELINE (1955)	38.168	LB MON IN WELL 5IN DN NE COR CARSON ST + CLARK AVE 31FT± N + 50FT± E C/L INT	SY 4997
BASELINE (1955)	50.057	L+T N CB 9FT± E BCR @ NE COR CARSON ST + LAKEWOOD DR 38FT± N + 54FT± E C/L INT MKD (BM)	SY 4998

QUAD-YEAR	ELEV	DESCRIPTION (INCLUDE QUAD AND YEAR IN DESCRIPTION)	BM NUMBER
BASELINE (1955)	50.249	L+T N CB 9FT± W BCR @ LAKEWOOD DR 38FT± N 50FT± W C/L INT MKD (BM)	SY 4999
BASELINE (1955)	55.636	USC+GS BR CAP E END CONC BRIDGE 100FT± W LAKEWOOD DR NR CTR GOLF COURSE 50FT± N C/L CARSON ST MKD (C780 1946)	SY 5000
BASELINE (1955)	55.674	SP HD BT E END HDWL CONC BRIDGE 100FT± W LAKEWOOD DR NR CTR GOLF COURSE 50FT± S C/L CARSON ST MKD (U)	SY 5001
BASELINE (1955)	56.577	RDBM TAG N CB 1FT± W ENT CATCH BASIN 40FT± N C/L + 25FT± E C/L PROD LEVELSIDE AVE	SY 5002
BASELINE (1955)	56.268	RDBM TAG S CB 40FT± S C/L CARSON ST + 3FT± W C/L PROD LEVELSIDE AVE	SY 5003
BASELINE (1955)	60.784	RDBM TAG N CB 2FT± E BCR @ NE COR CARSON ST + PARAMOUNT BLVD 40FT± N + 80FT± E C/L INT	SY 5004
BASELINE (1955)	61.649	RDBM TAG N CB 45FT± W BCR @ NW COR CARSON ST + PARAMOUNT BLVD 40FT± N + 120FT± W C/L INT	SY 5005
BELLFLWR (1960)	67.779	L+BRAD W CB 1FT± N BCR @ NW COR CARSON ST + DEEBOYER AVE 90FT± N + 18FT± W C/L INT MKD (BM)	SY 5006
BELLFLWR (1960)	69.304	RAM SET N CB 40FT± N C/L CARSON ST + 53FT± E C/L ERR TRACK NR CITY LIMITS LONG BEACH	SY 5007A
BELLFLWR (1960)	62.752	RDBM TAG N CB 1FT± E BCR @ NE COR CHERRY AVE + BIXBY AVE 30FT± N + 88FT± E SPLIT OF CBS	SY 5008A
BELLFLWR (1960)	62.747	RDBM TAG S CB 3FT± E BCR @ SE COR CHERRY AVE + BIXBY AVE 30FT± S + 91FT± E SPLIT OF CBS	SY 5009A
BELLFLWR (1960)	57.189	LONG BEACH MON IN WELL 8IN DN @ DR NR C/L INT 37TH ST + CHERRY AVE	SY 5010A
BELLFLWR (1960)	57.597	RDBM TAG E CB 74FT± E C/L CHERRY AVE + 33FT± N C/L PROD 37TH ST	SY 5011A
BELLFLWR (1960)	55.218	L+BRAD N SIDE CONC APRON OF DRWY TO REPUBLIC SUPPLY CO 48FT± E C/L CHERRY AVE + 513FT± N C/L WARDLOW RD MKD (BM)	SY 5012A
BELLFLWR (1960)	54.643	RDBM TAG E CB CHERRY AVE 40FT± E C/L NR CITY OF LAKEWOOD BOUNDARY 253FT± N C/L WARDLOW RD	SY 5013A
BELLFLWR (1960)	53.925	CITY OF LONG BEACH MON IN WELL 8IN DN ON NW COR CHERRY AVE + WARDLOW RD 5FT± N OF N CB + 45FT± W OF W CB MKD (BM 93)	SY 5014A
BELLFLWR (1960)	58.662	BR DISC VERTICAL IN NE COR WALL OF LONG BEACH WATER DEPT PUMP HSE SW COR CHERRY AVE + WARDLOW RD 70FT± S + 219FT± W C/L INT	SY 5015A
BASELINE (1955)	48.158	L+T W CB 3FT± N BCR @ NW COR PALO VERDE AVE + CANDLEWOOD ST 70FT± N + 28FT± W C/L INT MKD (BM)	SY 5016
BASELINE (1955)	37.006	RDBM TAG W CB 6FT± N BCR @ NW COR PALO VERDE AVE + CARSON ST 82FT± N + 30FT± W C/L INT	SY 5026
BASELINE (1955)	36.978	RDBM TAG E CB 6FT± N BCR @ NE COR PALO VERDE AVE + CARSON ST 82FT± N + 30FT± E C/L INT	SY 5027
BASELINE (1955)	42.870	L+SPK W CB 13FT± N BCR @ NW COR CARSON ST + SAN ANSELINE AVE 78FT± N + 28FT± W C/L INT	SY 5028
BASELINE (1955)	45.328	CS MON FLUSH W/WLK 2FT± NW CTR CB RET @ NW COR CARSON ST + WOODRUFF AVE 57FT± N + 48FT± W C/L INT MKD (K9 RM NO 3)	SY 5029

QUAD-YEAR	ELEV	D E S C R I P T I O N (INCLUDE QUAD AND YEAR IN DESCRIPTION)	BM NUMBER
BASELINE (1955)	42.620	RDBM TAG S CB OF N SERVICE RD 54FT± N C/L CARSON ST 150FT± E INT WOODRUFF AVE + CARSON ST OPP ENT TO WATER PUMP HSE	SY 5030
BASELINE (1955)	42.177	RDBM TAG N CB OF N SERVICE RD 82FT± N C/L CARSON ST 150FT± E INT WOODRUFF AVE + CARSON ST OPP ENT TO WATER PUMP HSE	SY 5031
BASELINE (1955)	56.602	L+T E CB 2FT± S BCR @ SE COR WOODRUFF AVE + ALLINGTON ST 76FT± S + 40FT± E C/L INT MKD (BM)	SY 5045
BASELINE (1955)	57.227	L+T N CB 12FT± E BCR @ NE COR WOODRUFF AVE + ALLINGTON ST 30FT± N + 83FT± E C/L INT MKD (BM)	SY 5046
BELLFLWR (1960)	61.963	RDBM TAG N CB 36FT± W BCR @ NW COR WOODRUFF AVE + ARTESIA BLVD 40FT± N + 112FT± W C/L INT	SY 5047
BASELINE (1955)	63.127	RDBM TAG 2FT± S BCR @ SW COR PARAMOUNT BLVD + WARWOOD RD 47FT± S + 76FT± W C/L INT	SY 5052
BASELINE (1955)	63.101	RDBM TAG W CB 2FT± N BCR @ NW COR PARAMOUNT BLVD + WARWOOD RD 48FT± N + 76FT± W C/L INT	SY 5053
BASELINE (1955)	61.095	RDBM TAG W CB 2FT± S BCR @ SW COR PARAMOUNT BLVD + GREENTOP ST 46FT S + 76FT± W C/L INT	SY 5054
BASELINE (1955)	60.807	RDBM TAG W CB 2FT± N BCR @ NW COR PARAMOUNT BLVD + GREENTOP ST 46FT± N + 76FT± W C/L INT	SY 5055
BASELINE (1955)	56.224	RDBM TAG W CB 9FT± S BCR @ SW COR PARAMOUNT BLVD + CENTRALIA ST 53FT± S + 76FT± W C/L INT	SY 5056
BASELINE (1955)	54.903	RDBM TAG W CB 2FT± N BCR @ NW COR PARAMOUNT BLVD + CENTRALIA ST 47FT± N + 76FT± W C/L INT	SY 5057
BASELINE (1955)	64.396	R D MON NR N END CONC HDWL CULV 27FT± E C/L MAIN TRACK SPRR 45FT W C/L ALAMEDA ST E BARREL 17FT S C/L PROD RAYMOND ST MKD (19)	SY 5783
BASELINE (1955)	64.231	USC+GS MON NR S END CULV HDWL 10FT± W C/L SPRR + 70FT± E C/L ALAMEDA ST W BARREL 90FT± N C/L PROD CALDWELL ST MKD (T 615 1941)	SY 5784
BASELINE (1955)	55.404	MWD MON 3FT E OF E CB ALAMEDA ST 26FT E C/L 42FT± N PP NO 241565E OPP GATE NO 18011 0.5MI± S ARTESIA BLVD MKD (56E 1933)	SY 5785
BASELINE (1955)	53.425	RDBM MON FLUSH 4FT E OF E CB ALAMEDA ST 26FT± E C/L + 19FT± S PP NO 241565E 61FT± S OF S END CONC CULV 0.5MI± S ARTESIA BLVD MKD (BM 15)	SY 5786
BASELINE (1955)	49.785	USC+GS MON NR N END SFRR CULV HDWL 8FT W C/L SFRR TRACKS 67FT E C/L ALAMEDA ST + 450FT± S C/L INT ALAMEDA ST + PERR MKD (F52 1926)	SY 5787
BASELINE (1955)	26.529	R D MON 6IN DN ALAMEDA ST 27FT W C/L + 225FT S C/L CARSON ST MKD (BM 7)	SY 5788
BASELINE (1955)	21.788	R D MON 4IN DN 3FT± W OF W CB ALAMEDA ST 25FT± W C/L 1070FT± S 223RD ST 30FT S PP NO 444418E MKD (BM 6)	SY 5789
BASELINE (1955)	21.954	R D MON 6IN DN 3FT W OF W CB ALAMEDA ST 25FT± W C/L 13FT S GP NO 444419 1145FT S 223RD ST MKD (BM 5)	SY 5790
BASELINE (1955)	16.632	R D MON W CB ALAMEDA ST 35FT W C/L 281FT± N C/L SEPULVEDA BLVD 45FT± S CATCH BASIN MKD (Y 3)	SY 5791

JUL 1964

LCS ANGELES COUNTY ROAD DEPARTMENT
 SURVEY SECTION FIELD ENGINEERING DIVISION

PAGE 17

QUAD-YEAR	ELEV	DESCRIPTION (INCLUDE QUAD AND YEAR IN DESCRIPTION)	BM NUMBER
BASELINE (1955)	37.041	CS MON IN CONC POST 2IN UP LAC BOUNDARY LINE 80FT± S SPUR TRACK TO TANK FARM 600FT± W ALAMEDA ST 3.5MI± S SEPULVEDA BLVD MKD (CC SUR RE 5869 LA CO-LA CITY)	SY 5792
BASELINE (1955)	41.612	L+BN CONC BASE CHAIN LINK FENCE POST @ GATE TO SPUR TRACK INTO (ETHYL CORT) YD 50FT± N TRACK 86FT± N C/L DIRT ROAD (LOMITA BLVD) 90FT± W CONC ENT ROAD 3.4MI± E WILMINGTON AVE	SY 5793
BELLFLWR (1960)	64.917	RD BM TAG W CB 2FT S BCR @ SW COR ATLANTIC AVE + ALONDRA BLVD 57FT± S + 36FT± W C/L INT	SY 6116
BELLFLWR (1960)	64.417	RD BM TAG W CB 33FT± N BCR @ NW COR ATLANTIC AVE + ALONDRA BLVD 105FT± N + 36FT± W C/L INT	SY 6117
BELLFLWR (1960)	64.755	L+T W CB 1FT± S BCR @ SW COR ATLANTIC AVE + LINSLEY ST 26FT± S + 36FT± W C/L INT	SY 6118
BELLFLWR (1960)	64.755	L+SPK E CB 6FT± S BCR @ SE COR ATLANTIC AVE + LINSLEY ST 35FT± S + 36FT± E C/L INT	SY 6119
BELLFLWR (1960)	65.375	L+T E CB 2FT± S BCR @ SE COR ATLANTIC AVE + MYRRH ST 27FT± S + 36FT± E C/L INT	SY 6120
BELLFLWR (1960)	65.384	L+T W CB 1FT± S BCR @ SW COR ATLANTIC AVE + MYRRH ST 26FT± S + 36FT± W C/L INT	SY 6121
BASELINE (1955)	31.942	CS MON 10IN DN 14FT± S + 72FT± W C/L INT DOMINGUEZ ST + SANTA FE AVE MKD (BM 8-57 RE 63)	SY 6146
BASELINE (1955)	54.269	BT SPK IN CONC ABUT OF UPRR + PERR CROSSING OVER LONG BEACH FREEWAY NR DOMINGUEZ ST 18FT± W OF W RAIL PERR + 8FT± N OF N RAIL UPRR	SY 6147
BASELINE (1955)	57.509	CS BR DISK CTR S HDWL W CONC ABUT UPRR BRIDGE OVER LA RIVER @ MILE POST 17.13 10FT± E /F W END HDWL MKD (BM 8-54B 1960)	SY 6148
BASELINE (1955)	57.552	CHIS SQ TOP NE COR CONC ABUT 9FT± N OF N RAIL UPRR @ W END BRIDGE OVER LA RIVER @ MILE POST 17.13	SY 6149
BASELINE (1955)	57.633	CS BR DISK CTR N HDWL E CONC ABUT 6FT± E UPRR BRIDGE OVER LA RIV @ MILE POST 17.13 MKD (BM 8-54B 1960)	SY 6150
BASELINE (1955)	44.407	USC + GS DISK 3FT± ABOVE GROUND IN E FACE OF W CONC ABUT UPRR BRIDGE OVER LONG BEACH BLVD 1FT± S OF N END ABUT + 49FT± S /F S CB 48TH ST + 14FT± W OF W CB LONG BEACH BLVD MKD (Z-799 1946)	SY 6151
BASELINE (1955)	102.987	4IN BR TABLET IN WELL 18FT± N OF S CB LINE PROD SAN ANTONIO DR + 33FT± E OF W CB LINE PROD LONG BEACH BLVD MKD (LA COUNTY SURVEY CONTROL SYSTEM TRAVERSE STATION CLEARWATER B-8A RE 2177)	SY 6152
BASELINE (1955)	88.489	4IN BR TABLET IN WELL 40FT± E OF W CB PROD LONG BEACH BLVD + 31FT± S OF N CB PROD WARDLOW RD MKD (LA COUNTY SURVEY CONTROL SYSTEM TRAVERSE STATION CLEARWATER B-10 RE 2177)	SY 6153
BASELINE (1955)	74.15	OUT LONG BEACH CITY BR CAP 12IN DN 49FT± N C/L SPRING ST + 27FT± E C/L CHERRY AVE + 4FT± SW FIRE HYDRANT MKD (LBBM)	SY 6154
BASELINE (1955)	24.651	LONG BEACH CITY ENG MON IN WELL IN LEFT TURN LANE OF N BARREL SPRING ST 8FT± N OF N CB + 16FT± E OF W END CTR ISLAND @ INT OF LAKEWOOD BLVD + SPRING ST MKD (CITY ENGINEER MONUMENT)	SY 6155

JUL 1964

LOS ANGELES COUNTY ROAD DEPARTMENT
SURVEY SECTION FIELD ENGINEERING DIVISION

PAGE 18

QUAD-YEAR	ELEV	D E S C R I P T I O N (INCLUDE QUAD AND YEAR IN DESCRIPTION)	BM NUMBER
BASELINE (1955)	22.748	L+BRAD IN CHIS SQ N CB 4FT± W BCR @ NW COR SPRING ST + WOODRUFF AVE 45FT± N + 78FT± W C/L INT	SY 6156
BASELINE (1955)	23.327	L+BRAD E CB 1FT± N BCR @ NE COR SPRING ST + WOODRUFF AVE 40FT±E + 54FT±N C/L INT	SY 6157
BASELINE (1955)	21.988	L+BRAD IN CHIS SQ W CB 6FT± S BCR @ SW COR SPRING ST + SNOWDEN AVE 100FT± S + 18FT± W C/L INT	SY 6158
BASELINE (1955)	23.396	RDBM TAG S CB 1FT± E BCR @ SE COR SPRING ST + SNOWDEN AVE 45FT± S + 48FT± E C/L INT	SY 6159